

ELECTRICAL DATA

FREQUENCY : DC-6GHz

IMPEDANCE: 50Ω

VSWR:1.35:1 MAX.

DIELECTRIC WITHSTANDING VOLTAGE: 500 Vrms

WORKING VOLTAGE: 170 Vrms MAX.

INSULATION RESISTANCE: 1000Mega Ohms

MECHANICAL DATA

COUPLING METHOD:THREADED

DURABILITY(MATING/UNMATING):10000 Cycles

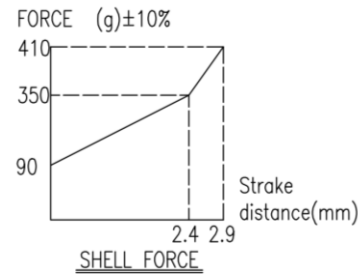
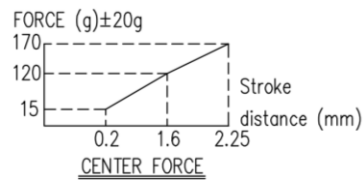
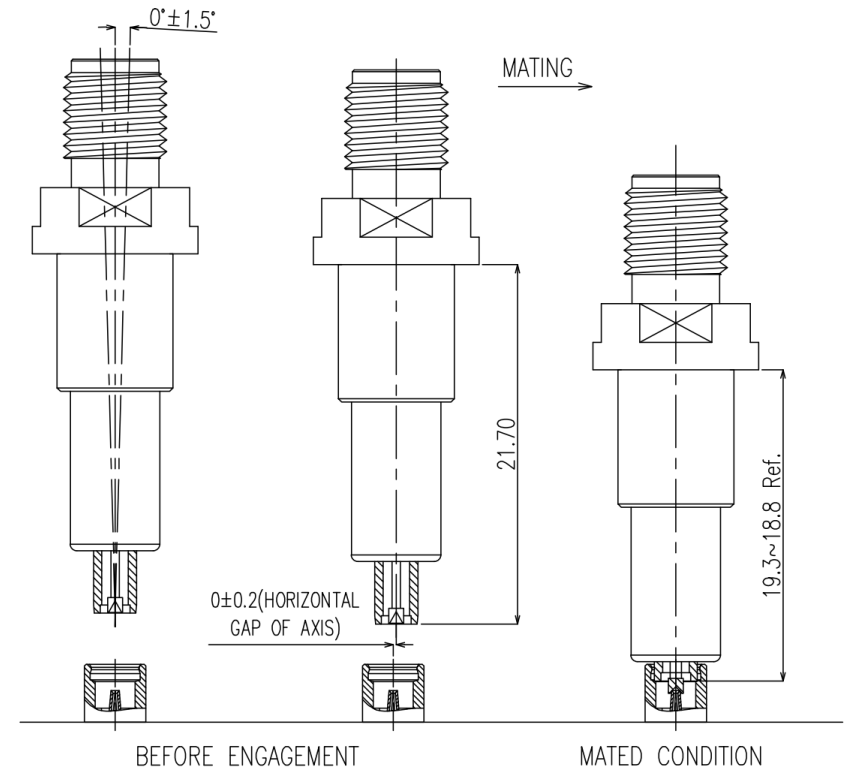
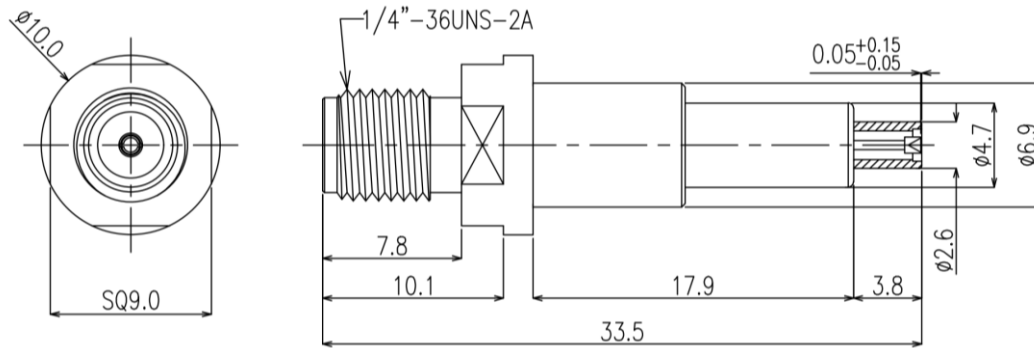

DESCRIPTION	MATERIALS	ROHS COMPLIANCE	UNIT: mm
BODY	BRASS, NICKEL/GOLD PLATED	TOLERANCE:X \pm 0.38 X.X \pm 0.25 X.XX \pm 0.15	
CENTER PIN	BRASS/BE-CU,GOLD PLATED	TITLE	
SPRING	SUS304	MMCX Male To SMA Female Probe, DC-6GHz	
INSULATOR	TEFLON		

NOTES

1. ALL SPECIFICATIONS ARE SUBJECT TO CHANGE WITHOUT NOTICE AT ANY TIME
2. CUSTOMER OUTLINE DRAWING FOR REFERENCE ONLY

MVE 芝程科技有限公司
Microwave

www.micro-mve.com

DC-67GHz RF& Microwave Components

PART NO.

MVE1983

REV
3.2

SIZE: A

SHEET: 1/1

SCALE:

Typical Test Result

PART NUMBER	DESCRIPTION
MVE1983	MMCX Male To SMA Female Probe, DC-6GHz

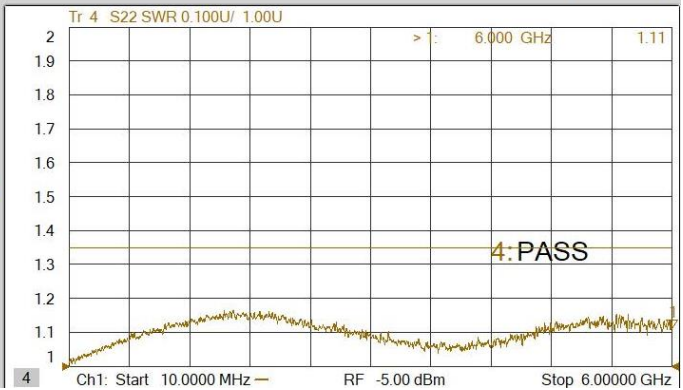
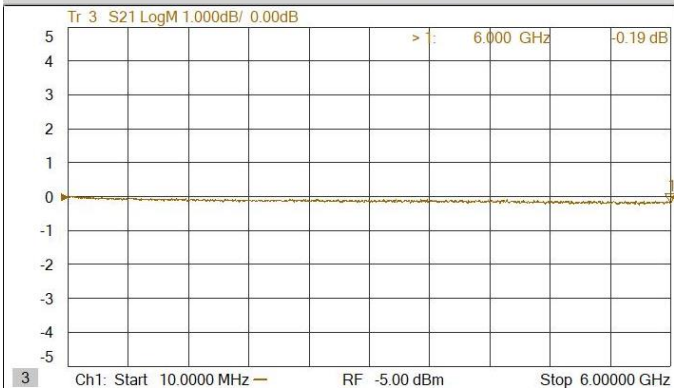
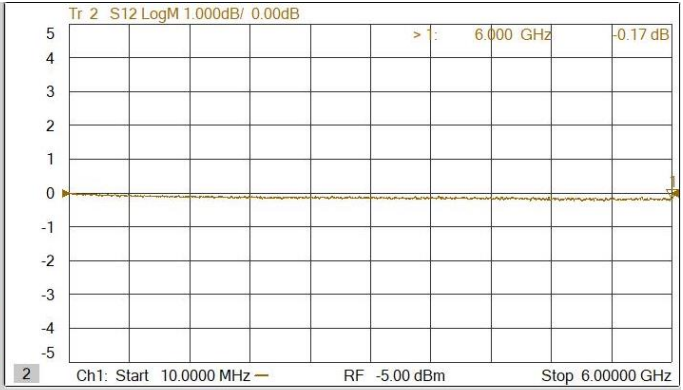
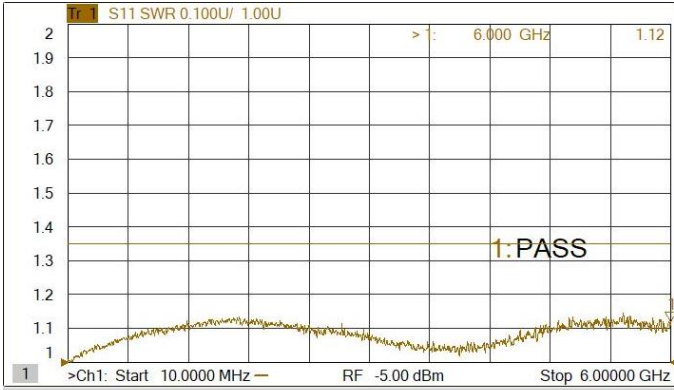

NOTES

- 1. ALL SPECIFICATIONS ARE SUBJECT TO CHANGE WITHOUT NOTICE AT ANY TIME
- 2. CUSTOMER OUTLINE DRAWING FOR REFERENCE ONLY