

COAXIAL CIRCULATOR

1.5-3.0 GHz
SMA Series

Features

- ✓ Frequency range: 1500-3000MHz
- ✓ Low Insertion Loss
- ✓ High Isolation



Specifications

Connector Type: SMA FEMALE

Direction: Clockwise

Operating Temperature: -20 °C ~+85°C

PART NUMBER	FREQUENCY (GHz)	VSWR (Max.)	INSERTION LOSS (Max.)	ISOLATION (Min.)	FORWARD POWER
MVE7135B	1.5 – 3.0	1.35:1(0~+60°C)	0.6 dB(0~+60°C)	17 dB(0~+60°C)	100W CW
		1.58:1(-20~+85°C)	0.8 dB(-20~+85°C)	14 dB(-20~+85°C)	

Tolerance: ±0.5mm

Outline Drawing (Unit: mm)

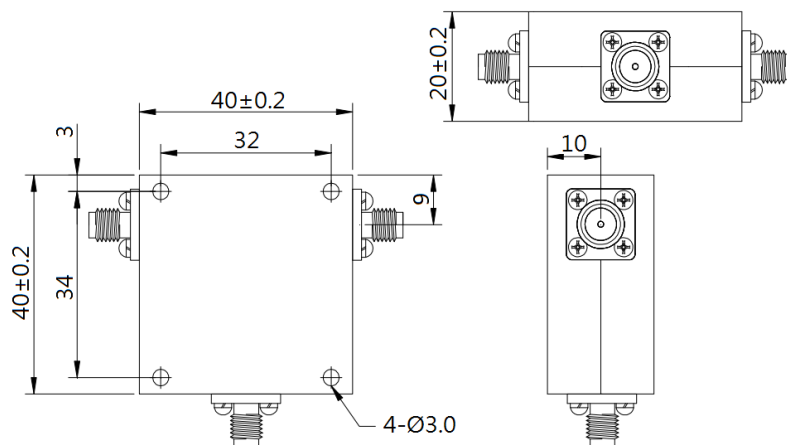

NOTES:

- ALL SPECIFICATIONS ARE SUBJECT TO CHANGE WITHOUT NOTICE AT ANY TIME
- CUSTOMER OUTLINE DRAWING FOR REFERENCE ONLY

Typical Test Result

