

COAXIAL ADAPTER

SMA TO U.FL Test Probe

Features

- ✓ Frequency up to 6GHz
- ✓ Low VSWR
- ✓ High Life Cycle



Specifications

PART NUMBER	MVE1997-3	
DESCRIPTION	50 ohm SMA Female To U.FL Plug Probe, DC-6GHz(ST2)	
ELECTRICAL		MATERIALS
FREQUENCY: DC-6GHz IMPEDANCE: 50 Ohm VSWR: 1.2:1 MAX DIELECTRIC WITHSTANDING VOLTAGE: 300Vrms INSULATION RESISTANCE: 500 MEGAOHMS		BODY: BRASS, NICKEL PLATED CENTER CONTACT: PHOSPHOR BRONZE SPRING CONTACT: PIANO WIRE INSULATOR: TEFLON
MECHANICAL DATA		TEMPERATURE
COUPLING METHOD: SNAP ON DURABILITY (MATING/UNMATING): 15000 Cycles EXTRACTION FORCE: 0.3 N MIN.		TEMPERATURE RANGE: -40°C to+ 85°C

Tolerance: X=± 0.38 X.X= ±0.25 .XX= ±0.15

Outline Drawing (Unit: mm)

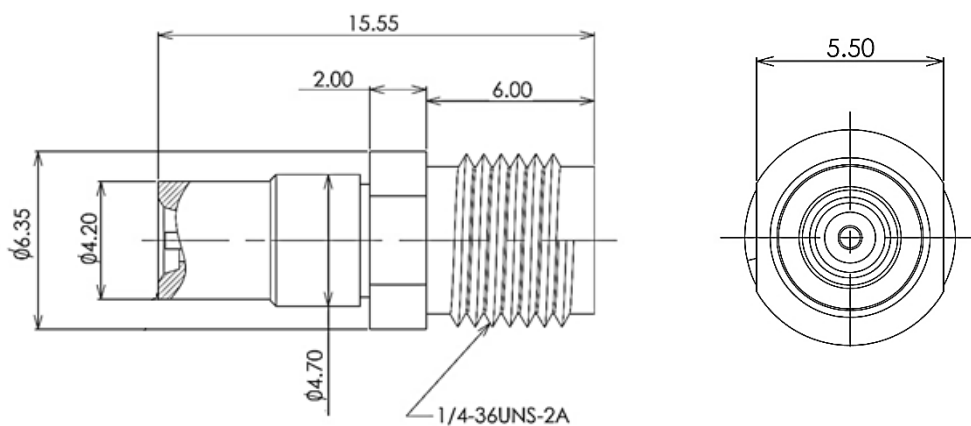

NOTES:
 1. ALL SPECIFICATIONS ARE SUBJECT TO CHANGE WITHOUT NOTICE AT ANY TIME.
 2. CUSTOMER OUTLINE DRAWING FOR REFERENCE ONLY.



Typical Test Result

PART NUMBER	DESCRIPTION
MVE1997-3	SMA Female To U.FL Plug Probe, DC-6GHz(ST2)

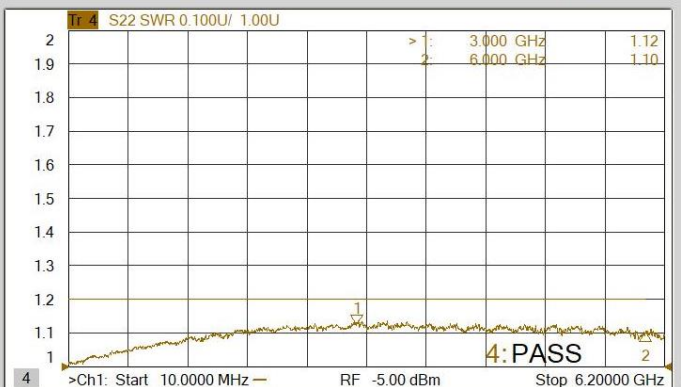
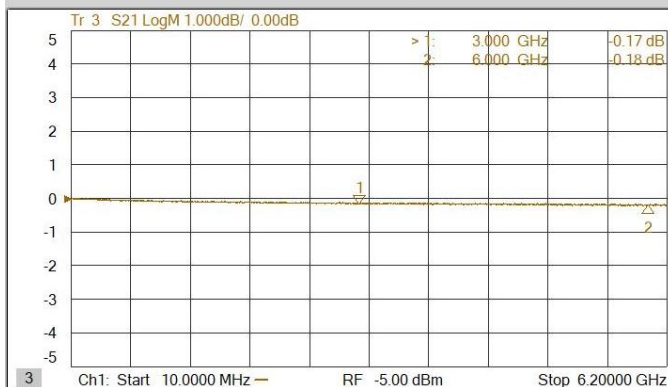
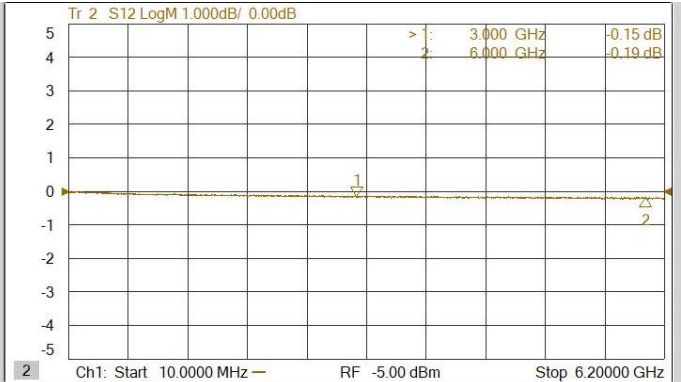
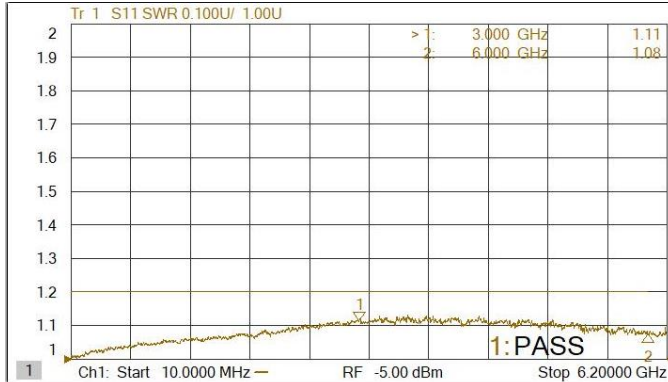

NOTES:

1. ALL SPECIFICATIONS ARE SUBJECT TO CHANGE WITHOUT NOTICE AT ANY TIME.
2. CUSTOMER OUTLINE DRAWING FOR REFERENCE ONLY.