

ELECTRICAL DATA

FREQUENCY : DC-6GHz

IMPEDANCE: 50Ω

VSWR: 1.3:1 MAX. (DC-6GHz)

INSERTION LOSS: 1.0 dB MAX.(DC-6GHz)

DIELECTRIC WITHSTANDING VOLTAGE : 1500 Vrms

MECHANICAL DATA

COUPLING METHOD: THREADED

TEMPERATURE RANGE: -35°C to 165°C

DURABILITY : 10,000 CYCLES

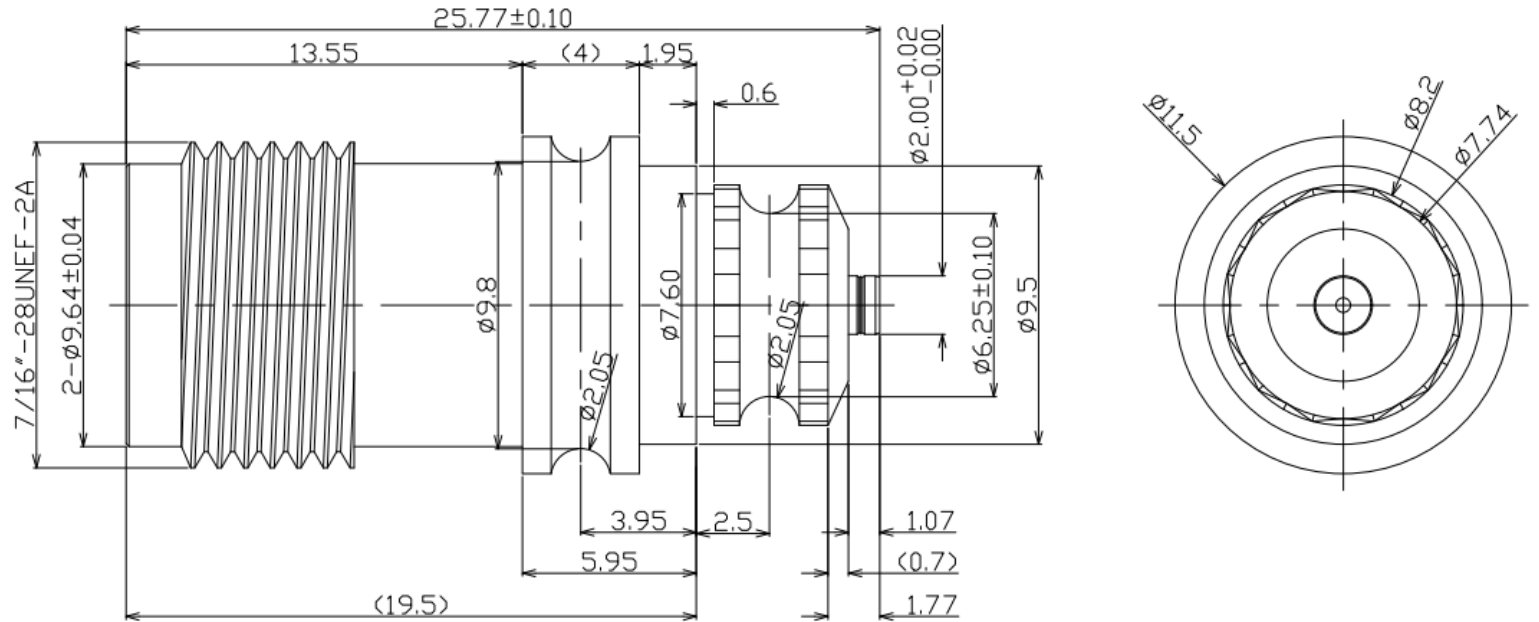

DESCRIPTION	MATERIALS	ROHS COMPLIANCE	UNIT: mm
PLATING	BLACK NICKEL	TOLERANCE: X=±0.2 X.X=±0.1 X.XX=±0.05	
BODY	STAINLESS STEEL	TITLE	
CONDUCTOR	BRASS,GOLD PLATED	MHF Female To TNC Female	
INSULATOR	TEFLON	Adapter,DC-6GHz /Stainless(Pin 5U")	

MVE 芝程科技有限公司

www.micro-mve.com

DC-67GHz RF& Microwave Components

PART NO.

MVE1991-2H

REV

1.2

SIZE: A

SHEET: 1/1

SCALE:

NOTES

1. ALL SPECIFICATIONS ARE SUBJECT TO CHANGE WITHOUT NOTICE AT ANY TIME
2. CUSTOMER OUTLINE DRAWING FOR REFERENCE ONLY