

COAXIAL CONNECTOR

SMA MALE For RG402 CABLE

Features

- ✓ Frequency up to 26.5GHz
- ✓ High Durability
- ✓ High performance design



Specifications

PART NUMBER	MVE3993-18.1
DESCRIPTION	SMA Male for .141(RG402) Connector, Clamp DC-26.5GHz/Stainless
ELECTRICAL	MATERIALS
FREQUENCY: DC-26.5GHz IMPEDANCE: 50Ω VSWR: 1.3:1 MAX. WORKING VOLTAGE: 500V INSULATOR RESISTANCE: 5000MΩ MIN. DURABILITY: 500 CYCLES	BODY: BRASS, GOLD PLATED CONTACT: BRASS, GOLD PLATED SHELL: STAINLESS, PASSTIVATED

Tolerance: ±0.5mm

Outline Drawing (Unit: mm)

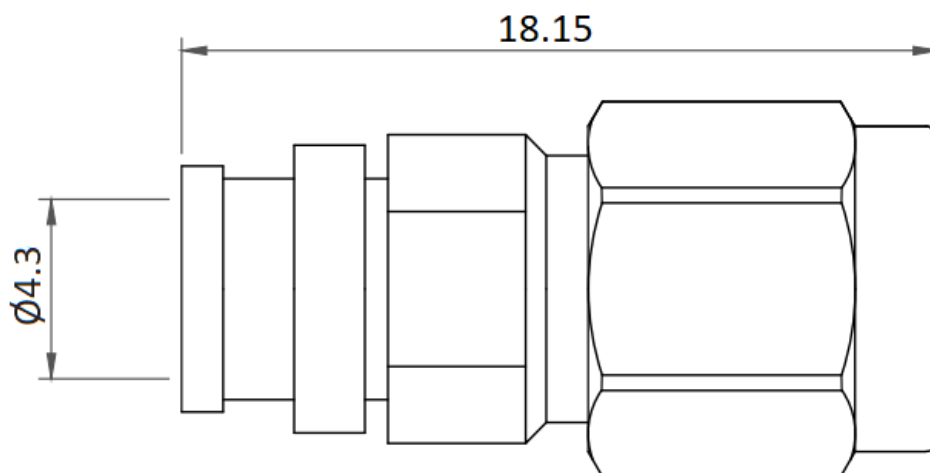

NOTES:

1. ALL SPECIFICATIONS ARE SUBJECT TO CHANGE WITHOUT NOTICE AT ANY TIME
2. CUSTOMER OUTLINE DRAWING FOR REFERENCE ONLY

