

COAXIAL CONNECTOR

SMA PCB DIP Type

Features

- ✓ Frequency up to 12.4GHz
- ✓ Low VSWR
- ✓ SMA Female R/A Interface

Specifications

PART NUMBER	MVE3108-15.1
DESCRIPTION	SMA Female R/A For PCB Connector, DIP DC-12.4GHz
ELECTRICAL	MATERIALS
FREQUENCY: DC-12.4GHz IMPEDANCE: 50 ohm VSWR: 1.50:1 MAX. WORKING VOLTAGE: 500Vrms MAX. DIELECTRIC WITHSTANDING VOLTAGE: 1000Vrms MAX. INSULATOR RESISTANCE: 1000MEGOHMS MIN.	BODY: BRASS, GOLD PLATED CONTACT: BE COPPER, GOLD PLATED 20u" INSULATOR: TEFLON

TOLERANCE: X=±0.2 X.X=±0.1 X.XX=±0.05

Outline Drawing (Unit: mm)

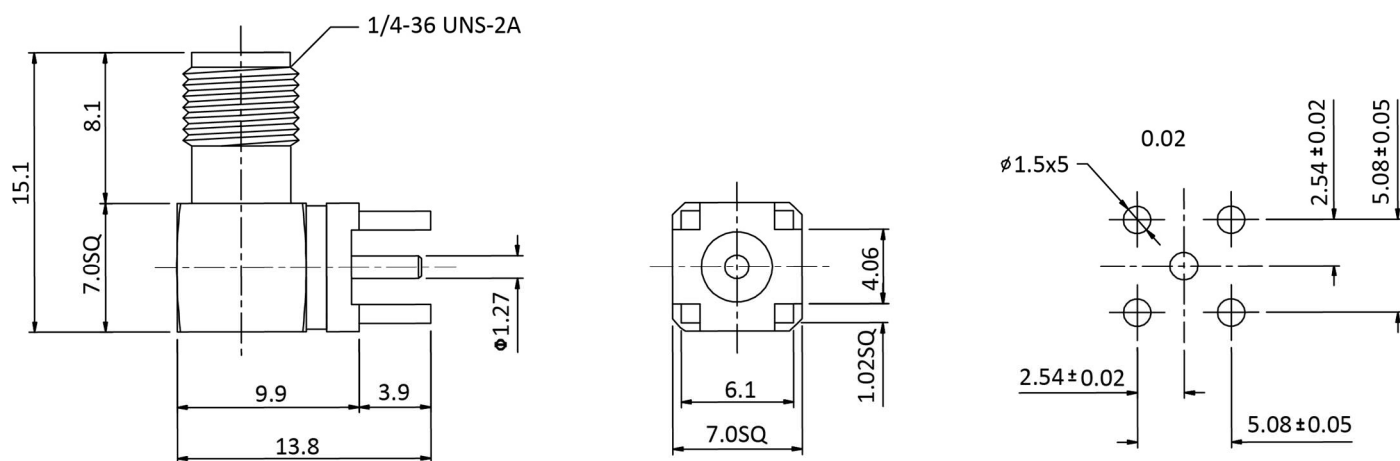

Recommended PCB Hole

NOTES:

1. ALL SPECIFICATIONS ARE SUBJECT TO CHANGE WITHOUT NOTICE AT ANY TIME
2. CUSTOMER OUTLINE DRAWING FOR REFERENCE ONLY

