

# WAVEGUIDE MAGIC TEE

WR28

## Features

- ✓ Frequency Range: 34-36GHz
- ✓ WR-28 waveguide design, connect to UG-599/U flange
- ✓ Customer specify center frequency and bandwidth

## Specifications

<b>PART NUMBER</b>	MWR5071
<b>DESCRIPTION</b>	WR28 Waveguide Magic Tee, 34-36GHz
<b>ELECTRICAL</b>	<b>MATERIALS</b>
FREQUENCY : 34-36GHz WAVEGUIDE: WR28 VSWR: 1.35:1 Max. INSERTION LOSS: 0.5dB Max. ISOLATION: 25dB Min. FLANGE: UG-599/U	BODY: COPPER INSIDE FINISH: SILVER PLATING OUTSIDE FINISH: CORROSION PROTECTED WITH BLUE PAINT TEMP RANGE: -30°C~+70°C

## Outline Drawing (Unit: mm)

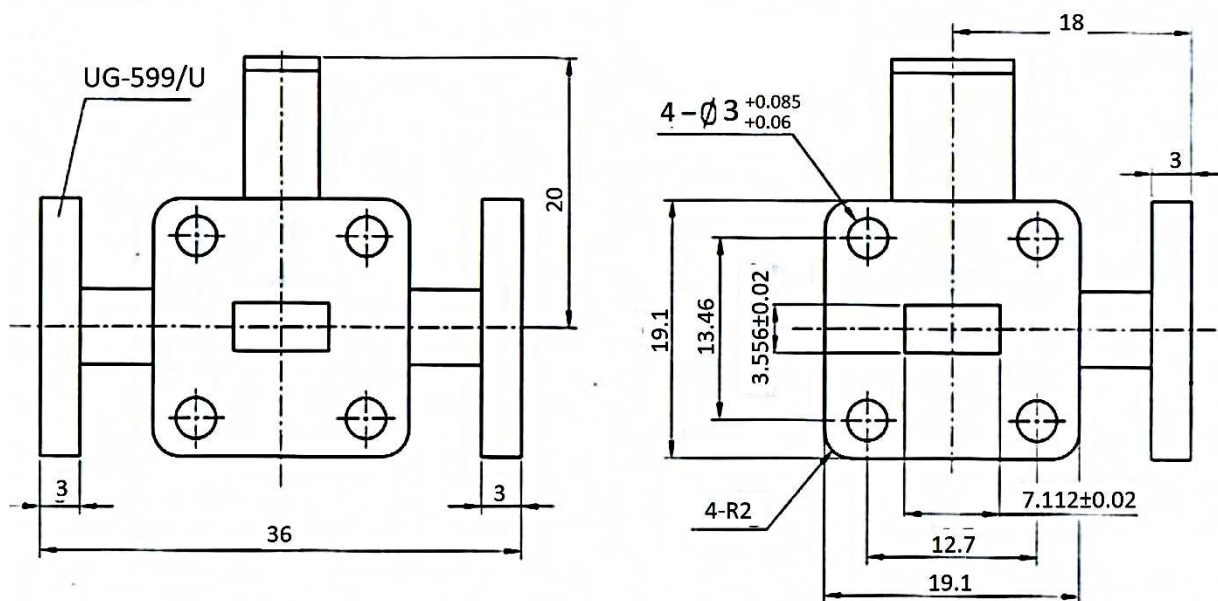

NOTES:

1. ALL SPECIFICATIONS ARE SUBJECT TO CHANGE WITHOUT NOTICE AT ANY TIME
2. CUSTOMER OUTLINE DRAWING FOR REFERENCE ONLY

