

# SWITCH

## MVE9212

**SPDT**  
**FAILSAFE TTL**

### Features

- ✓ Frequency up to 18 GHz
- ✓ Low Insertion Loss
- ✓ High Life Cycles



### SPECIFICATIONS

RF CHARACTERISTICS					
FREQUENCY RANGE	0-2GHz	2-4GHz	4-8GHz	8-12GHz	12-18 GHz
VSWR MAX.	1.15:1	1.20:1	1.30:1	1.4:1	1.5:1
INSERTION LOSS MAX.	0.20dB	0.20dB	0.25dB	0.35dB	0.4dB
ISOLATION MIN.	90dB	80dB	75dB	65dB	60dB
AVERAGE POWER AT COOL SWITCHING	50WATTS				
ELECTRICAL CHARACTERISTICS					
ACTUATOR	FAILSAFE TTL				
COIL CURRENT	DC 12V DC 24V 、 DC 28V (option )				
DRIVE VOLTAGE	2.5-5V				
DRIVE CURRENT	0.02-0.8mA				
MECHANICAL CHARACTERISTICS					
CONNECTORS	SMA Female				
LIFE CYCLES	1,000,000				
SWITHCING TIME	<20ms				
WEIGHT	45g				
ENVIRONMENTAL CHARACTERISTICS					
OPERATING TEMPERATURE	-40°C~+85°C				
STORAGE TEMPERATURE	-55°C~+85°C				

NOTES:

1. ALL SPECIFICATIONS ARE SUBJECT TO CHANGE WITHOUT NOTICE AT ANY TIME
2. CUSTOMER OUTLINE DRAWING FOR REFERENCE ONLY



Tolerance: X= ±5%

### Outline Drawing (Unit: mm)

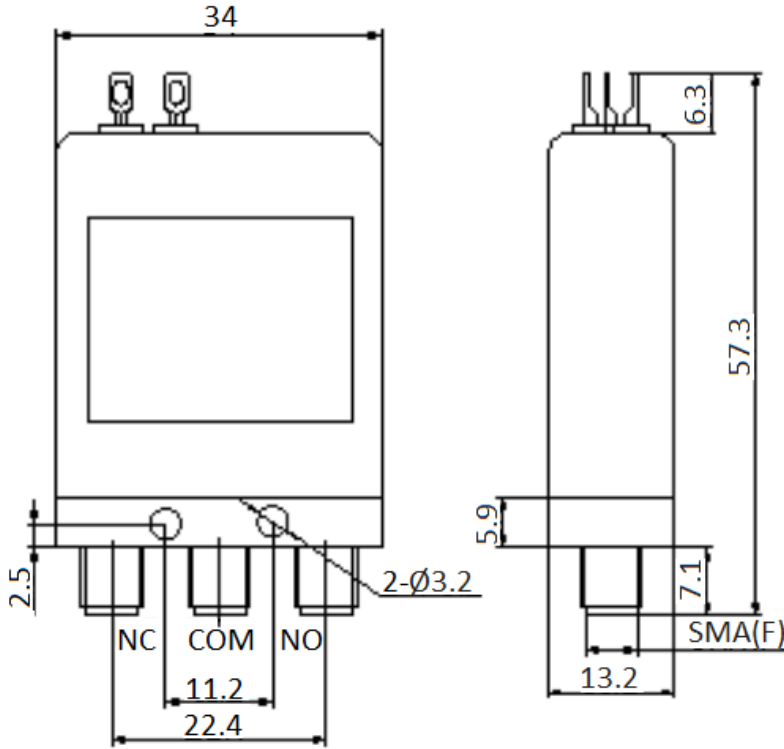

### Electrical Schematic:

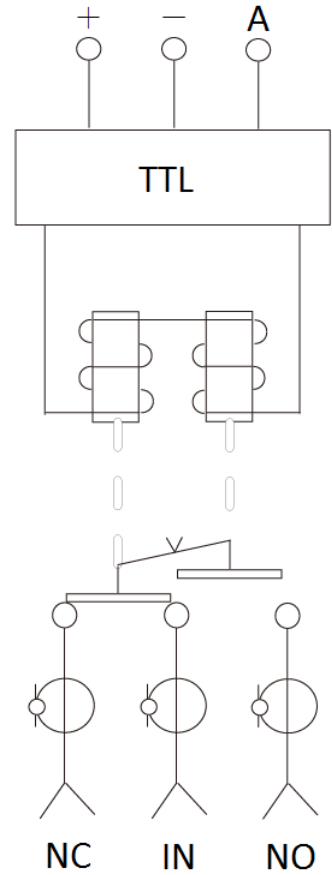

\*NOTE: ALUMINUM BODY (Aluminum scratches more easily than more durable materials.)

### SCHEMATIC DIAGRAM

PIN	CONTROL	DRIVE VOLTAGE(V)	DRIVE CURRENT (mA)
1	1+	DC12	150mA
2	GND	/	/
3	A	2.5-5	0.02-8

NOTES:

1. ALL SPECIFICATIONS ARE SUBJECT TO CHANGE WITHOUT NOTICE AT ANY TIME
2. CUSTOMER OUTLINE DRAWING FOR REFERENCE ONLY



## Typical Test Result

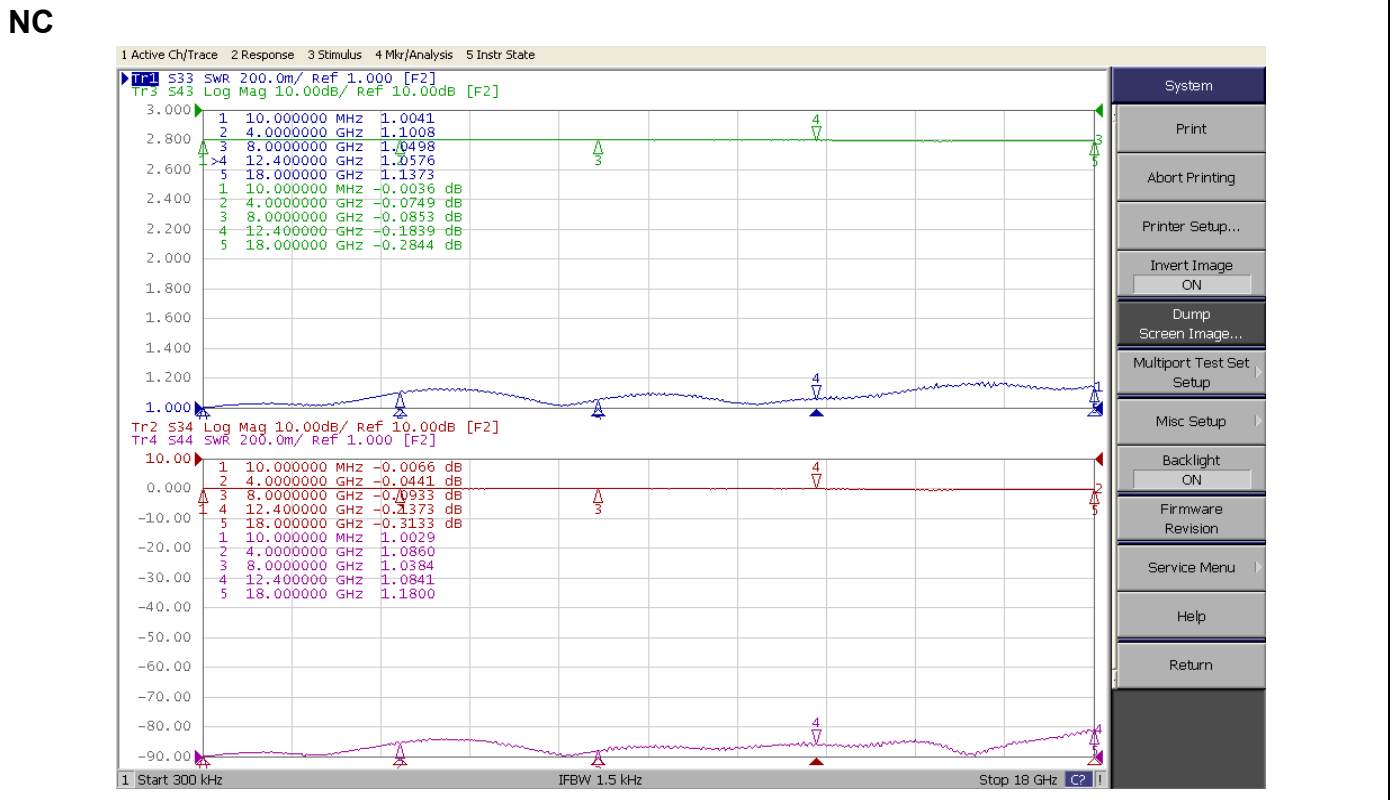

### NC ISOLATION

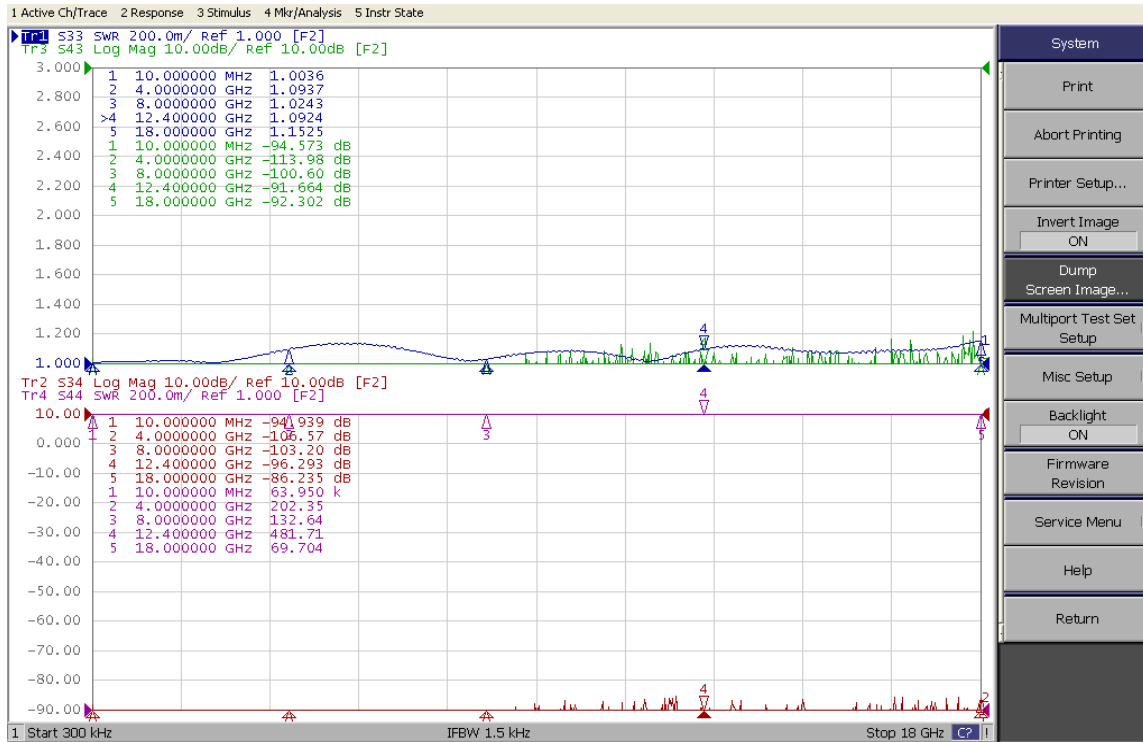

### NO

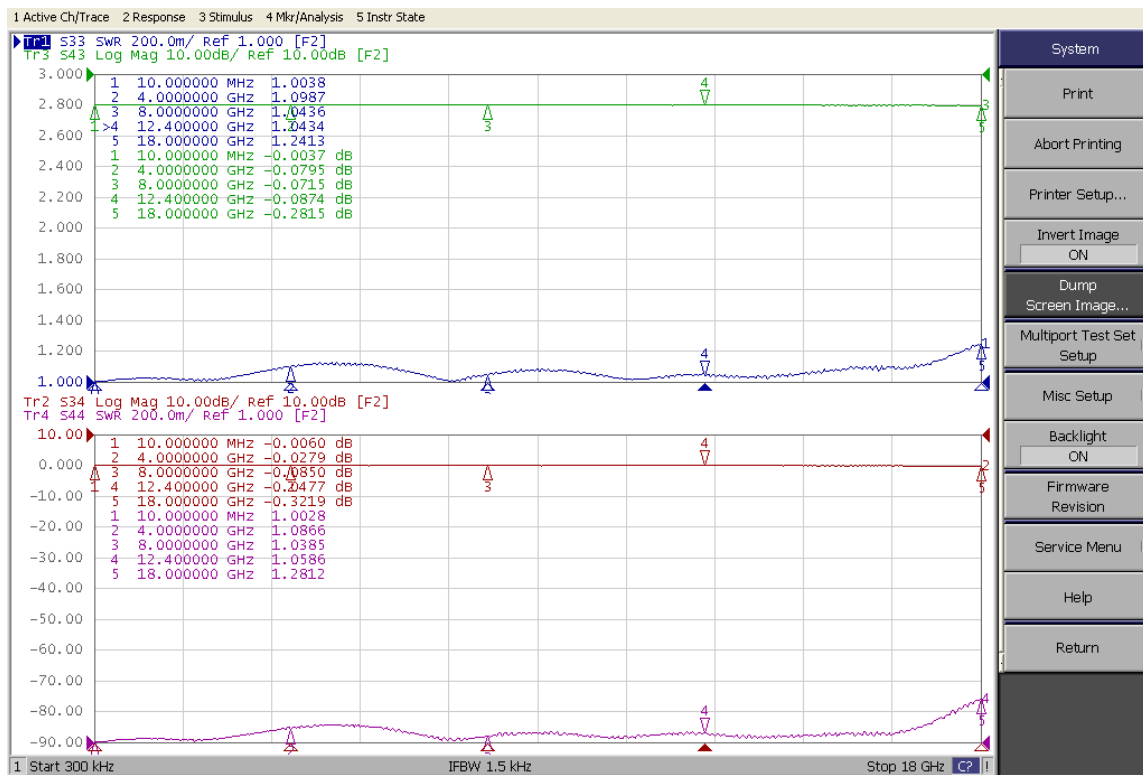

## NO ISOLATION

