

# COAXIAL CIRCULATOR

**350-512MHz**  
**SMA Series**

## Features

- ✓ Frequency range cover from 350-512MHz
- ✓ Small size, SMA female connector In/out
- ✓ Low VSWR and low insertion loss

## Specifications

CONNECTOR TYPE: SMA FEMALE

DIRECTION: CLOCKWISE 1→2→3

PART NUMBER	FREQUENCY (MHz)	VSWR	INSERTION LOSS	ISOLATION	POWER HANDLING	TEMPERATURE
MVE7137	350-512	≤1.35:1@25°C	≤0.7dB@25°C	≥16dB@	50W	-40~+70°C
		≤1.40:1@-40~+70°C	≤0.9dB@-40~+70°C	-40~+70°C		

Tolerance:±0.15mm

## Outline Drawing (Unit: mm)

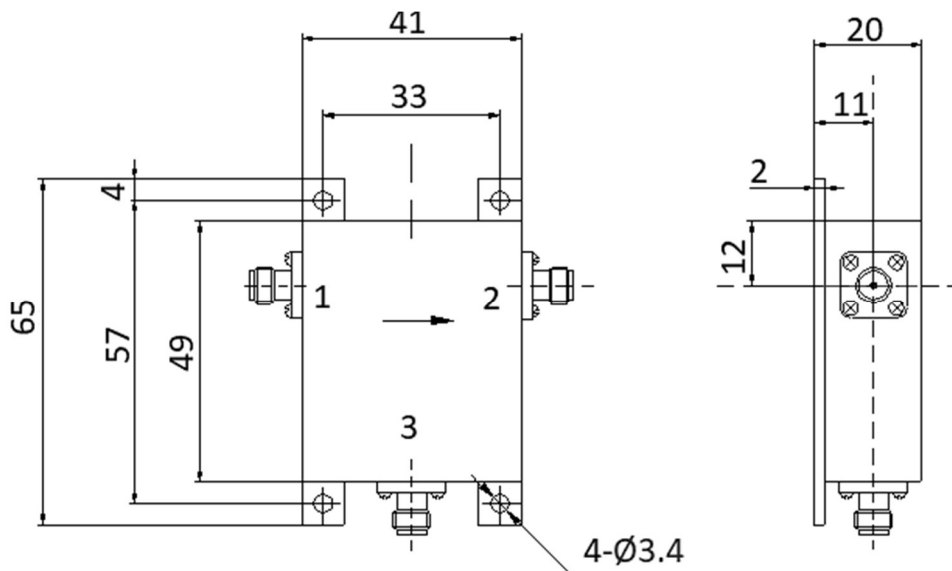

NOTES:

1. ALL SPECIFICATIONS ARE SUBJECT TO CHANGE WITHOUT NOTICE AT ANY TIME
2. CUSTOMER OUTLINE DRAWING FOR REFERENCE ONLY

