

ROTARY ATTENUATOR

MVE2R61-50 ----- DC to 6GHz 0-60dB 10 dB/Step

MVE2R62-50 ----- 0-10dB 1 dB/Step

Features

- ✓ Excellent Accuracy Value
- ✓ Low VSWR, unconditional stable
- ✓ SMA female connector I/O (option: N)



Specifications

PART NUMBER	IMPEDANCE	FREQUENCY	ATTENUATION RANGE	ATTENUATION STEP	INSERTION LOSS	VSWR MAX.	CONNECTOR
MVE2R61-50	50 OHMS	DC-6GHz	0-60 dB	10 dB	1.0	1.4:1	SMA FEMALE
MVE2R62-50			0-10 dB	1 dB			

*Option Connector: N Female

ATTENUATION ACCURACY

MVE2R61-50: $\pm 0.50\text{dB} (<40\text{dB}) / \pm 0.8 \text{ dB or } \pm 3\% (\geq 40\text{dB})$
MVE2R62-50: $\pm 0.5 \text{ dB}$

MATERIALS

CONNECTOR: BRASS, NICKEL PLATED
CENTOR CONDUCTOR: BERYLLIUM BRONZE, GOLD PLATED
HOUSING: BRASS NICKEL PLATED, ALUMINUM

WEIGHT - 210g
Tolerance: X= $\pm 5\%$

Outline Drawing (Unit: mm)

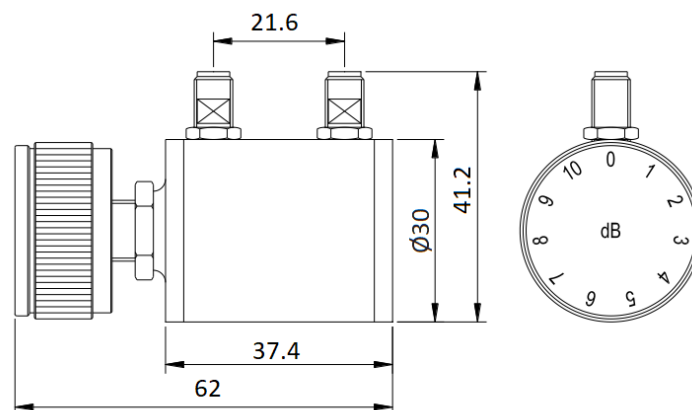

NOTES:

1. ALL SPECIFICATIONS ARE SUBJECT TO CHANGE WITHOUT NOTICE AT ANY TIME
2. CUSTOMER OUTLINE DRAWING FOR REFERENCE ONLY



Typical Test Result (MVE2R62-50/OdB)

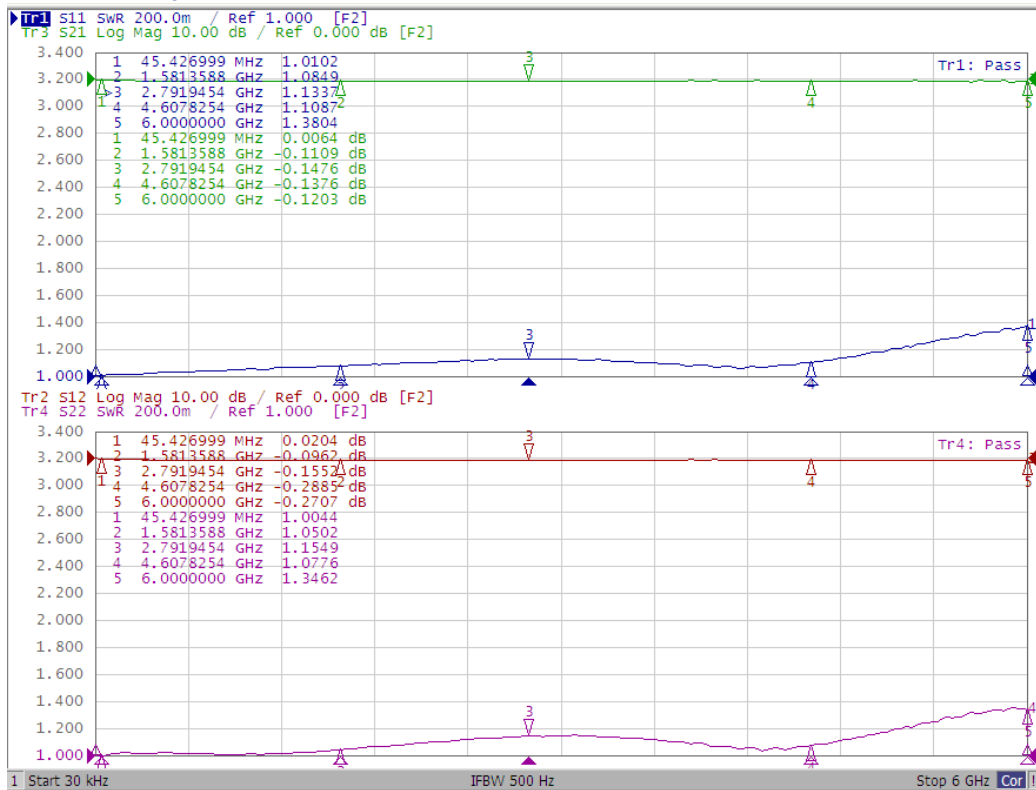

(MVE2R62-50/10dB)

