

WAVEGUIDE ADAPTER

3.5mm-WR90

Features

- ✓ X Band, 8.2-12.4GHz Frequency Range
- ✓ WR90 Waveguide Interface
- ✓ 3.5 mm Coaxial Interface



Specifications

PART NUMBER	MVE12066
DESCRIPTION	3.5mm Female To WR90, 8.20-12.4GHz Waveguide Adapter
ELECTRICAL	MATERIALS
FREQUENCY: 8.2-12.4GHz WAVEGUIDE: RECTANGULAR WAVEGUIDE WR90 CONNECTOR: 3.5mm Female VSWR: 1.25:1 MAX. INSERTION LOSS: 0.3dB MAX. FLANGE TYPE: FBP100 (COVER) OPERATION TEMPERATURE: -20°C ~ +70°C	BODY: COPPER/BRASS FINISH: INSIDE – SILVER PLATING OUTSIDE –ANTICORROSION GREY PAINT

Tolerance:±0.5mm

Outline Drawing (Unit: mm)

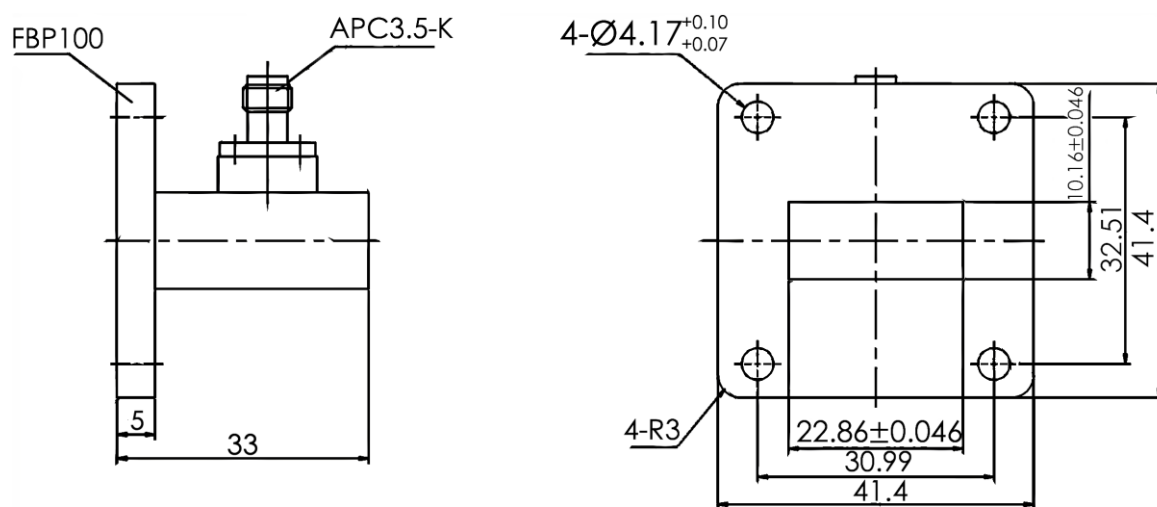

NOTES:

1. ALL SPECIFICATIONS ARE SUBJECT TO CHANGE WITHOUT NOTICE AT ANY TIME
2. CUSTOMER OUTLINE DRAWING FOR REFERENCE ONLY

Typical Test Report

VSWR

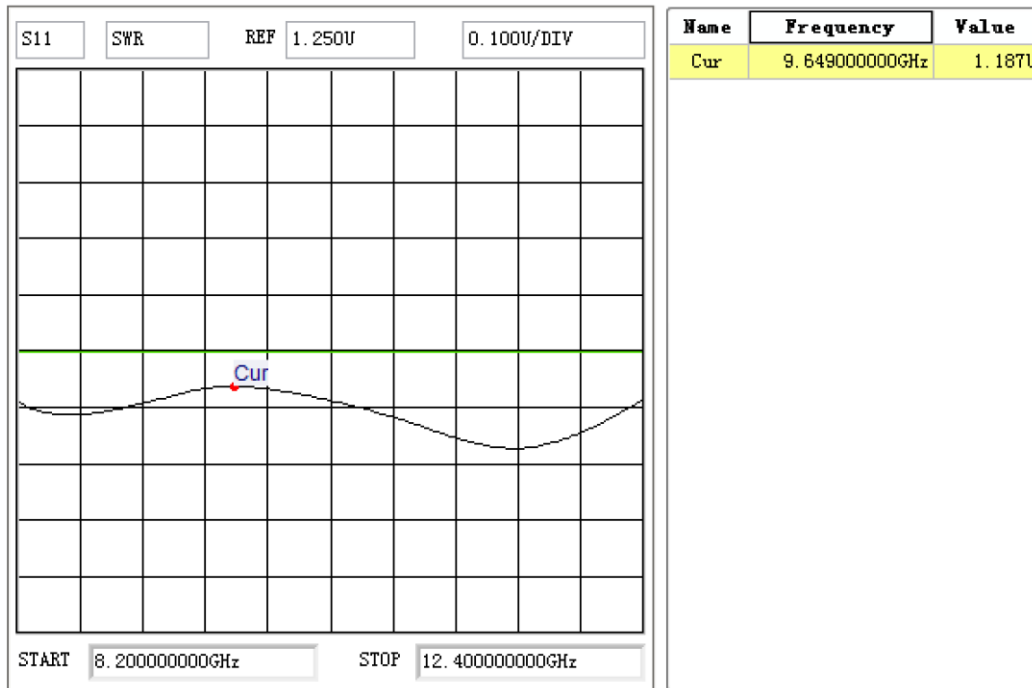

INSERTION LOSS

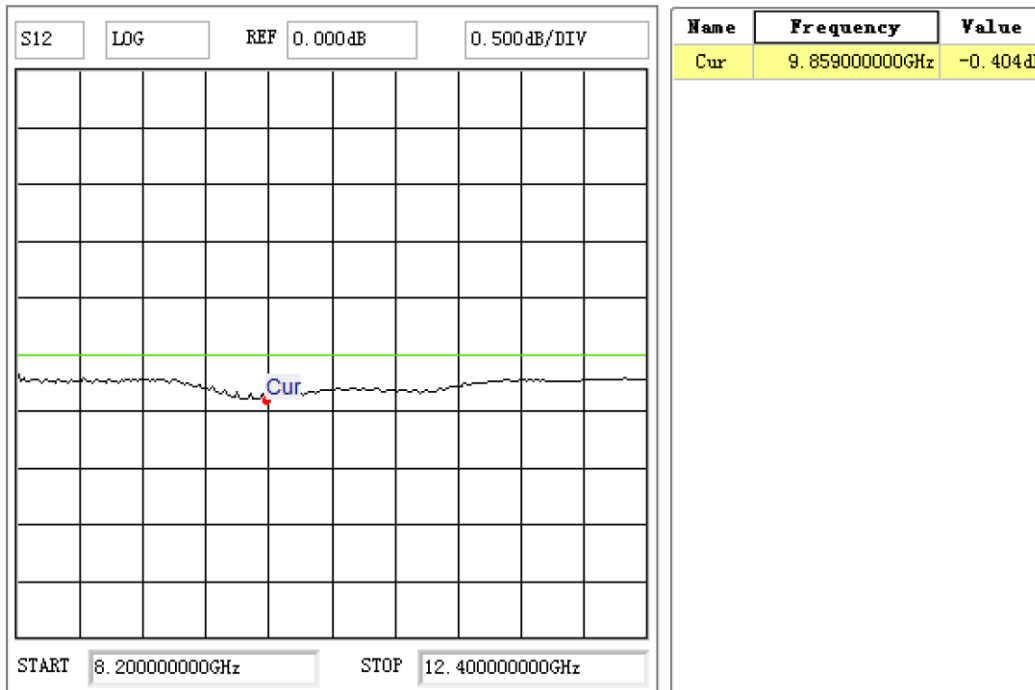

In IL test setup, two Waveguide to Coaxial Adaptors are connected together. The test result is the total IL of two Waveguide to Coaxial Adaptors. In calculation, dividing this result by 2 can get single Waveguide to Coaxial Adaptor's IL.

- NOTES:
1. ALL SPECIFICATIONS ARE SUBJECT TO CHANGE WITHOUT NOTICE AT ANY TIME
 2. CUSTOMER OUTLINE DRAWING FOR REFERENCE ONLY