

# COAXIAL ADAPTER

## 2.4mm-2.4mm Precision Series

### Features

- ✓ Frequency up to 50GHz
- ✓ 2.4mm Interface
- ✓ Low VSWR



### Specifications:

<b>PART NUMBER</b>	<b>MVE1139B</b>
<b>DESCRIPTION</b>	2.4mm Female To 2.4mm Female, 50GHz Adapter / Stainless
<b>ELECTRICAL</b>	FREQUENCY: DC-50GHz IMPEDANCE: 50Ω VSWR: 1.25:1 MAX. TEMPERATURE: -55°C ~+165°C
<b>MATERIALS</b>	BODY: STAINLESS STEEL, PASSIVATED INSULATOR: PEI PIN CONTACT: BERYLLIUM COPPER ALLOY, GOLD PLATED

Tolerance: X= ±0.5mm .X= ±0.2mm .XX= ±0.1mm

### Outline Drawing (Unit: mm)

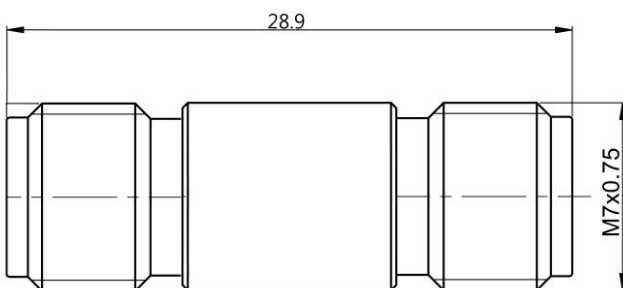

### Typical Test Result

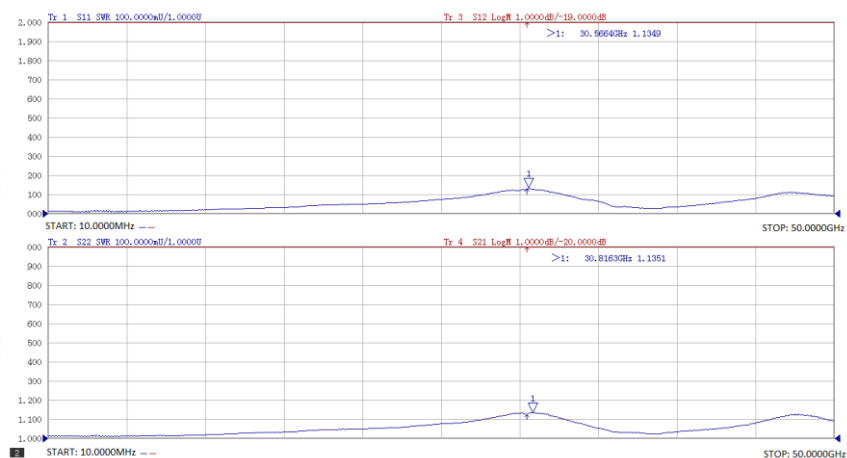

#### NOTES:

1. ALL SPECIFICATIONS ARE SUBJECT TO CHANGE WITHOUT NOTICE AT ANY TIME
2. CUSTOMER OUTLINE DRAWING FOR REFERENCE ONLY

